

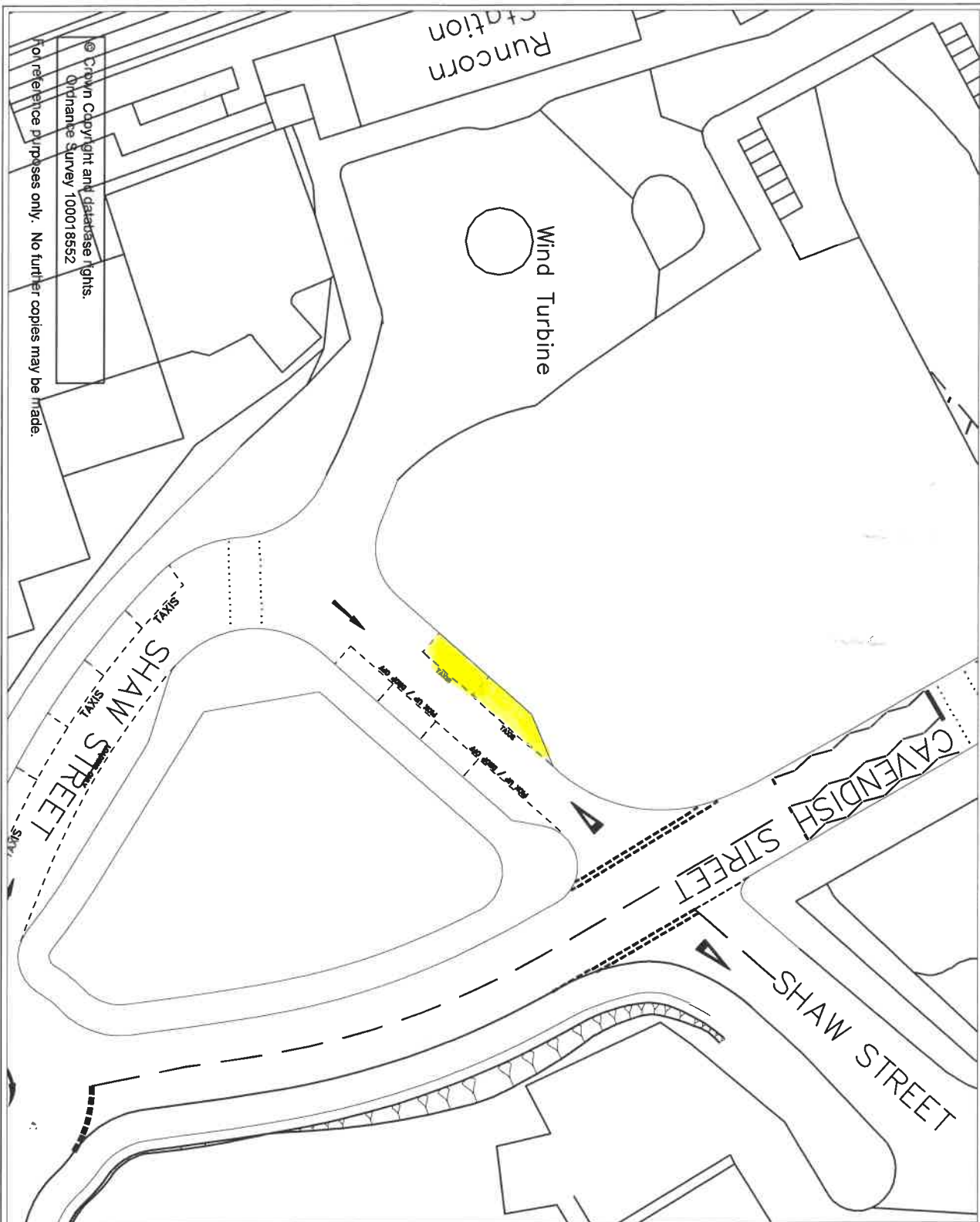

APPENDIX A



<p>Notes:</p> <p>21</p> <p>MAX. VEHICLES - 2</p> <p>ANY TIME</p>	<p>REVISIONS</p> <table border="1" style="width: 100%; border-collapse: collapse;"> <tr><td> </td><td> </td><td> </td></tr> <tr><td> </td><td> </td><td> </td></tr> <tr><td> </td><td> </td><td> </td></tr> <tr><td> </td><td> </td><td> </td></tr> </table>													 <p>HALTON BOROUGH COUNCIL</p> <p>POLICY, PLANNING & TRANSPORTATION DEPARTMENT</p> <p>T. 01828 8584, M65, 016, Shaw, WOTPI, MK6CS Operational Director Municipal Buildings, Kenworthy Wharfedale, W68 7GF. Tel: 02083 333 4300</p>	<p>SHAW STREET (RUNCORN STATION)</p> <p>TAXI RANK</p>
<p>Scale:</p> <p>1:500</p> <p>Drawn by:</p> <p>AS</p> <p>Plan No:</p> <p>HCS 21</p>	<p>Date:</p> <p>06/02/00</p> <p>Checked by:</p> <p> </p>	<p>Row:</p>	<p>© Crown Copyright and database rights. Ordnance Survey 100018552</p> <p>For reference purposes only. No further copies may be made.</p>												

APPENDIX B

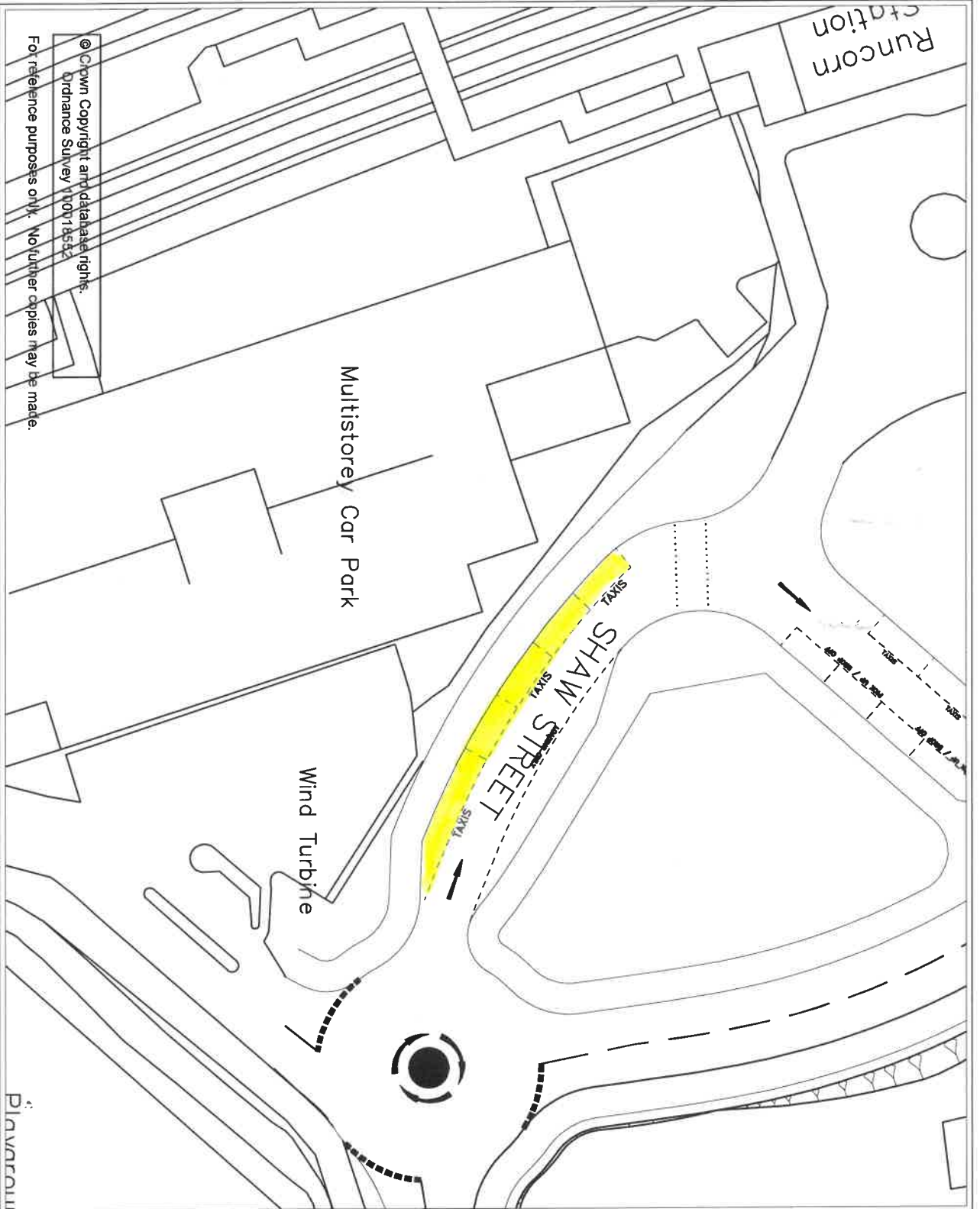

© Crown Copyright and database rights.
 Ordnance Survey 10018552
 For reference purposes only. No further copies may be made.

Note:
22
 MAX. VEHICLES - 5
 ANY TIME

REVISIONS

HALTON BOROUGH COUNCIL
 POLICY, PLANNING
 TRANSPORTATION DEPARTMENT
 T. Gabea BSc. MSc. Dip. Surv. MERTM MRCIS
 Operational Director
 Municipal Building, Kingsway
 Widnes, WA9 7DF, Tel: 0303 333 4300

**SHAW STREET
 (RUNCORN STATION
 FEEDER)
 TAXI RANK**

Scale:	Date:
1:500	05/2010
Drawn By:	Checked By:
ala	
Plan No:	Rev:
HCS 22	

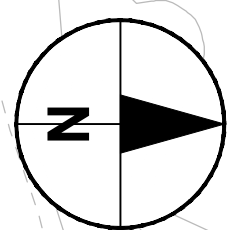

APPENDIX C

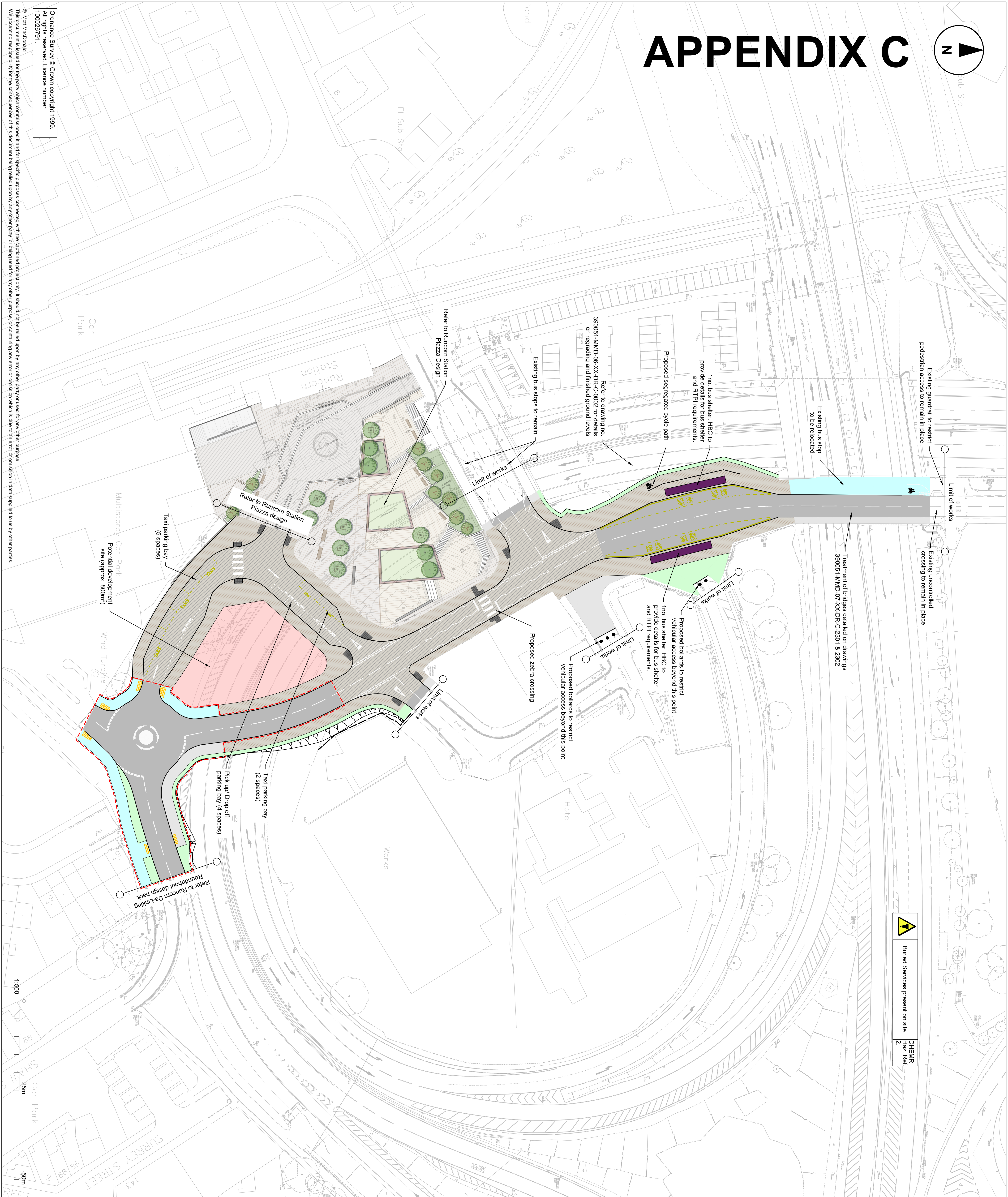

Buried Services present on site.
 DHEMR
 Haz. Ref.
 Z

- Notes
1. Do not scale from this drawing
 2. Design based on topographical survey supplied by Malcom Hughes in October 2018. Ref: 51405
 3. To be read in conjunction with General Arrangement Drawings 390051-MMD-01-XX-DR-C-0101 & 0102

Key to symbols

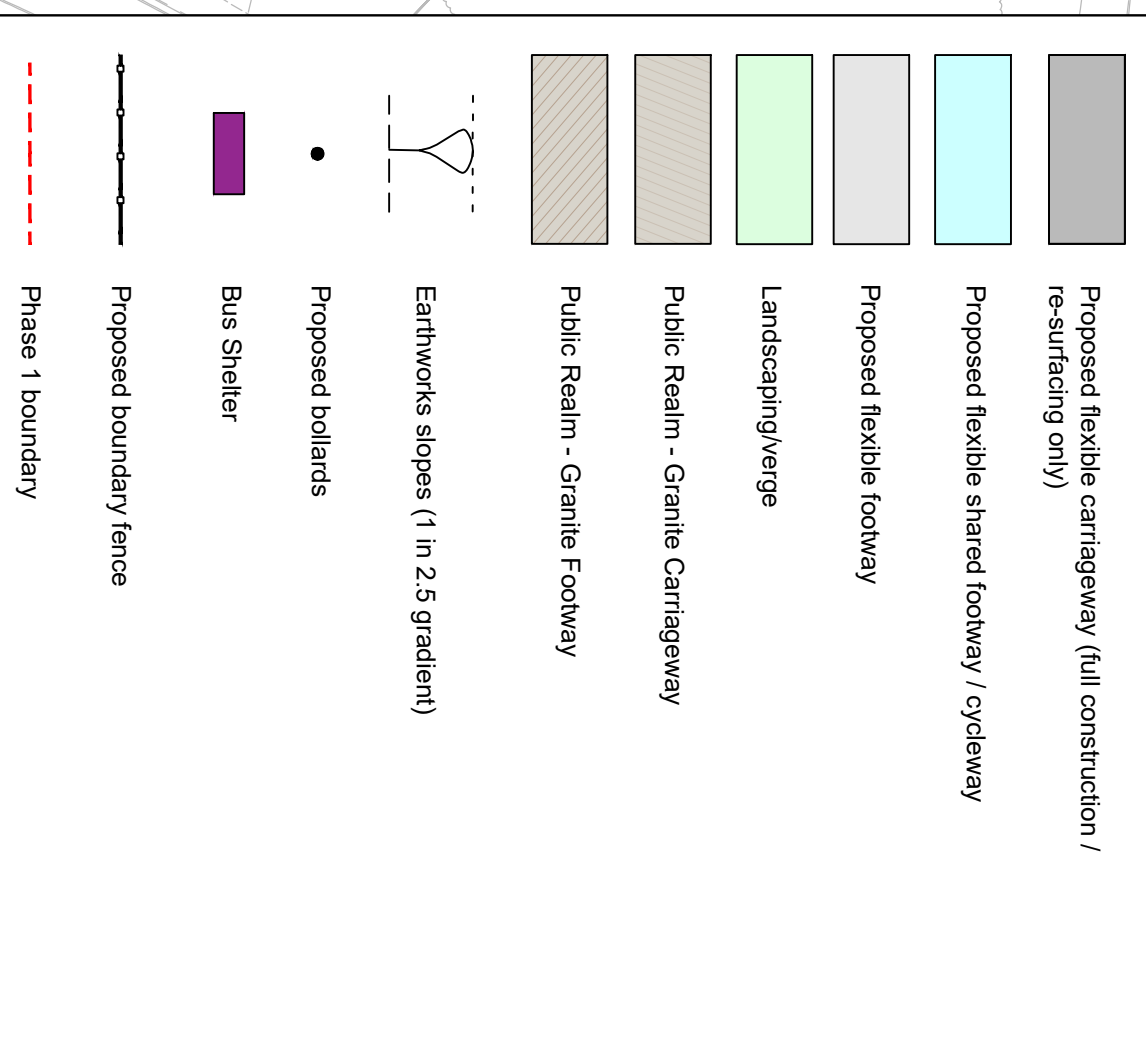

Reference drawings
 390051-MMD-01-XX-DR-C-0101 - Phase 1 General Arrangement Sheet 1 of 2
 390051-MMD-01-XX-DR-C-0102 - Phase 1 General Arrangement Sheet 2 of 2
 390051-MMD-06-XX-DR-C-0002 - Proposed General Arrangement

Rev	Date	Description	Drawn	CHK'd	App'd
A	15/05/2020	Construction Issue	JJ	PM	SA

M MOTT MACDONALD
 Mott MacDonald
 Royal Liver Building
 Liverpool, L3 1JH
 United Kingdom
 T +44 (0)151 482 9910
 D +44 (0)151 482 9910
 F +44 (0)151 236 2985
 W www.mottmac.com



Title
**Runcom De-Linking
 RSQ Highway Design
 General Arrangement**

Drawn	Checked	Eng check	P Mckee	PM
J Johnson	JJ	Eng check	P Mckee	PM
Dwg check	P Mckee	PM	Coordination	P Mckee
Scale at A1	Status	Rev	SA	SA
1:500	CON	A	Security	STD

Drawing Number
390051-MMD-07-XX-DR-C-0101

Ordinance Survey © Crown copyright 1999.
 All rights reserved. Licence number 100020791.
 © Mott MacDonald
 This document is issued for the party which commissioned it and for specific purposes connected with the captioned project only. It should not be relied upon by any other party or used for any other purpose.
 We accept no responsibility for the consequences of this document being relied upon by any other party, or being used for any other purpose, or containing any error or omission which is due to an error or omission in data supplied to us by other parties.
 P:\Mackees\Northwest\Projects (Gaul)\390051-HBC-RANV & WNV\Recon\102 Drawings\Highways2 - Detailed Design\Canadian Street Link Drawings\390051-MMD-07-XX-DR-C-0101_GA.dwg May 15, 2020 - 5:30PM MCG7124